

**SS-VCWD2**  
**SS-VCWD3**

**VOLUME CONTROL WITH 2-WAY DIVERTER**  
**VOLUME CONTROL WITH 3-WAY DIVERTER**

**Note:**

- USE TEFLON TAPE OR PIPE SEALANT FOR THREADED CONNECTIONS
- DO NOT USE PLUMBER'S PUTTY ON ANY OF THE BRASS COMPONENTS  
This will cause the finish to tarnish and void the warranty. A non-corrosive Alkoxy Silicone is recommended.
- DURING SWEATING OF LINES DO NOT OVERHEAT CASTING  
Overheating may cause damage to internal mechanism and void the manufacturer's warranty as well as increase the risk of scalding.
- COPPER ADAPTORS MAY BE REQUIRED TO COMPLETE YOUR INSTALLATION

**DIAGRAM A**

Measurements are from the tip of the nipple to the finished wall

Handle Trim #	Measurement (IN.)	Handle Trim #	Measurement (IN.)	Handle Trim #	Measurement (IN.)
A	2 1/4	CRY4/CRY5/D	2 1/4	SP4/SP5	1 3/8
AA	2 1/2	D5/D6	1 3/4	SW	2 1/8
AQ	1 1/4	DD	2 1/2	SWA	1 1/4
AX	2 1/4	DD2/DD3	1 1/8	SWU/T	1 7/8
AX less base ring	2 1/8	ED1/ED2/ED3/ED4	1 5/8	T1	1 3/4
AXP	2 1/4	E1/E2/E3	1 3/8	T4	1 5/8
AZ1	1 3/4	EV4	1 1/8	T6/T7/T8/T9	2 1/4
B4/B5	2 1/8	F/G	2 1/4	TIA/TIB/TIC	7/8
B9M/B9P	1 3/8	H	2 1/8	TR14/TR15	2 1/4
BB	2 1/2	H4	1 1/2	TR24/TR25	1 3/8
BG4/BG5/BK/BKA.1	2	HH/I	2 1/4	U	1 7/8
BL1	1/4	IN14/IN16	2 1/4	U1	2 3/8
BL2/BL3	3/4	J5/J6	1 3/4	U3/U5/U6/U7	2 1/8
BR4	1	KK	1 1/2	U8	1 1/8
BV01/BV02	2 1/2	L4/L5/L6/L8	1	V	1 3/8
BV05	1 1/4	L9	1 7/8	V1	5/8
BV09	2 1/4	LLD4/LLP5/LLO6	1 3/8	V2	1 1/4
BV13/BV15	1 3/4	MZ4/MZ5	2 1/8	W/WW	2 1/4
BV81	1 1/2	N2/N3/N4	1 1/2	WW less base ring	2 1/8
CC	2 5/8	N5	1 5/8	X	2
CC11	1 3/4	R1	3/4	XJ/XK/XM/XN/XO/XQ	1 3/8
CC20/CC21/CC22	1 3/8	R2	1 7/8	XX	2 1/4
CC30/CC31	2 1/4	R3	1 1/2	Y	2
CC40/CC41/CC42	1 3/8	RNS4/RNK8	1 3/8	Y2	1 3/8
CC51	1	S	2	YY	2 1/4
CC61	1 3/4	S1/S1A/S2/S3	1 3/8	Z	2
CL14/CL15	1 7/8	SA1	2	ZEN	1 1/2
CL16	1 3/8	SA2	2 1/4	ZZ	2 1/4

**NOTE: WHEN FITTING HANDLE IT MAY BE NECESSARY TO SHORTEN BROACH STEM AND/ OR THREADED NIPPLE TO MINIMIZE GAP BETWEEN HANDLE AND ESCUTCHEON.**

### Valve Installation

1. Place the valve rough body in position according to mudguard or according to installation Diagram A.
  - **For Diagram A, measure from the tip of the nipple to the finished wall.** Be sure to have additional stem length available in case of extra float for tile, marble or other surface material.
2. Sweat lines so that water follows arrow on valves.
3. Test valve after it is installed.
  - Run valve for 30 seconds and check for leaks
4. Once valve has been tested proceed to close wall up to mudguard (maximum 1 5/8" diameter hole).
5. Install Trim.
  - Mount and hand tighten escutcheon to thread nipple.
  - Install handle on valve. Stems can be cut down if necessary.
    - **NOTE:** Alignment kits are included with most trim to aid in positioning handles horizontally (Diagram D).
    - **NOTE:** If valve is set too far in the wall, 1" extension kits may be ordered: Model # SS-EXT20.

### Diagram B

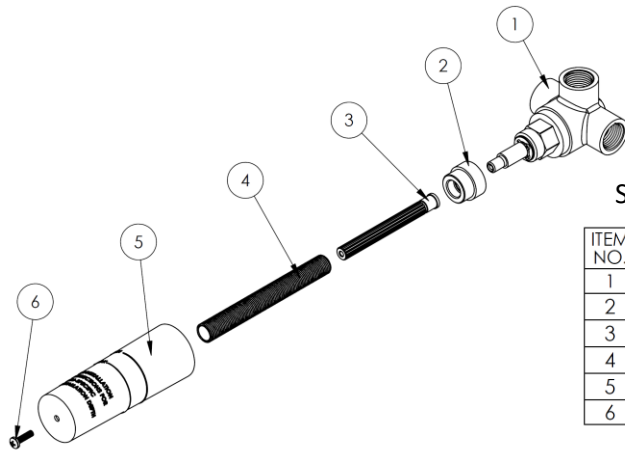

SS-VCWD2:

ITEM NO.	PART NUMBER	QTY.
1	SS-VCWD2-VLV	1
2	SS-VCWD-MID	1
3	SS-VCWD-STEM	1
4	SS-VCWD-NPPL	1
5	WALL-VLV-MDGRD	1
6	MDGRD SCREW	1

SS-VCWD3:

ITEM NO.	PART NUMBER	QTY.
1	SS-VCWD3-VLV	1
2	SS-VCWD-MID	1
3	SS-VCWD-STEM	1
4	SS-VCWD-NPPL	1
5	WALL-VLV-MDGRD	1
6	MDGRD SCREW	1

### Diagram C

SS-VCWD2:

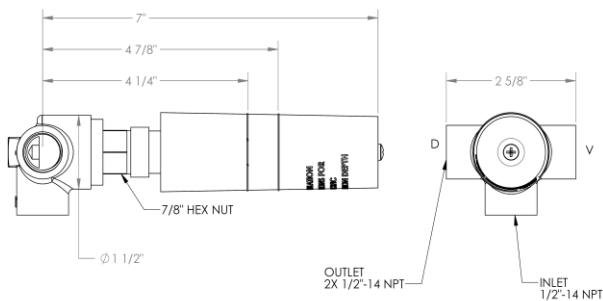

SS-VCWD3:

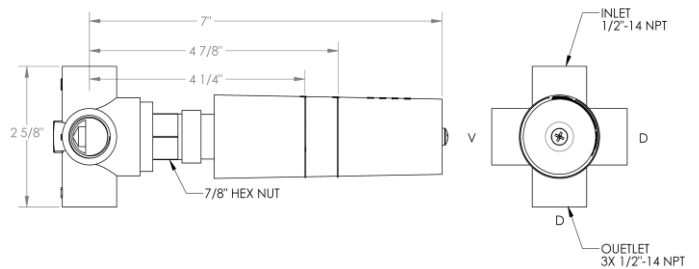

### Diagram D

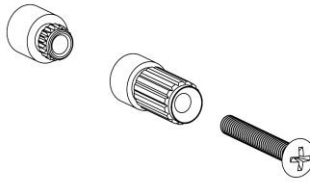

### Diagram E

SS-VCWD2:

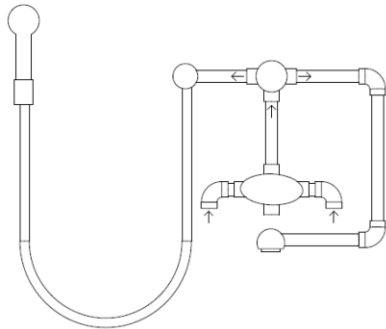
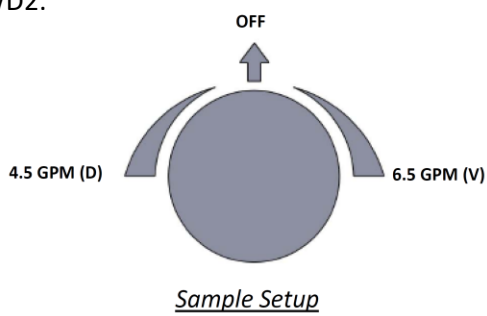

SS-VCWD3:

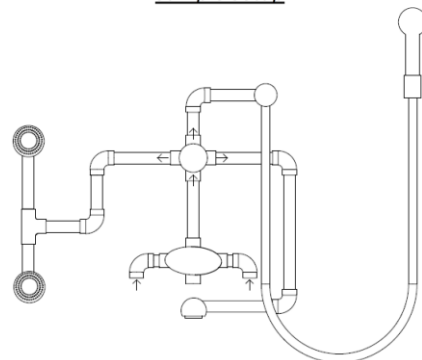
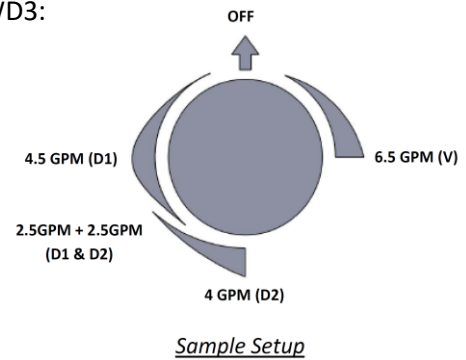

Rev. 8/2019